



Studios & Rehearsal Space
London City Island

About the English National Ballet at the **Mulryan Centre for Dance**

Our creative facilities at the Mulryan Centre for Dance offer the perfect space for events, rehearsals, technical and production work, meetings, training sessions, workshops and brand events.

Winner of the RIBA National Award for Architecture 2021, the building is home to English National Ballet and offers production, rehearsal and event facilities, just a 5-minute tube journey from Canary Wharf and with easy vehicular access from the A13.

With a Production Studio including a full fly tower, state of the art rehearsal studios, and various meeting and hospitality spaces, English National Ballet at London City Island offers spaces in which hirers can develop, create, share, and promote their work and practice as well as entertain clients in a world class creative environment.

Spaces can be hired for:

- Rehearsals & Studio Performances
- Technical & Production
- Auditions
- Meetings
- Training
- Product Launches
- Networking Events





Space Specifications

Holloway Production Studio

The Holloway Production Studio is a blank canvas space and can be used as a productive technical theatre space, an engaging training space, or can transform into a magical hospitality venue.

With a full height fly tower and a stage space to match London's largest theatres, the Holloway Production Studio offers a technical space in which to rehearse and produce performances.

Features

- Full height fly tower and access from loading bay
- Bleacher seating for 175 with more seating available according to preferred layout
- Space can be split into different segments e.g. presentation space & hospitality space or running wardrobe/company office space as well as stage area
- Grand piano available to hire

Size

19m x 26m

Floor to top of Fly tower: 24.2m

Capacity

500 standing

300 theatre

[Visit the Holloway Production Studio on our Virtual Tour](#)

Start from £5,000 pd | £22,500 pw*

* All prices exclude VAT. Please note that prices are starting prices only, based on daytime hire - please contact us for a bespoke quote for evening and/or extended hours use. Weekend rates available upon request.

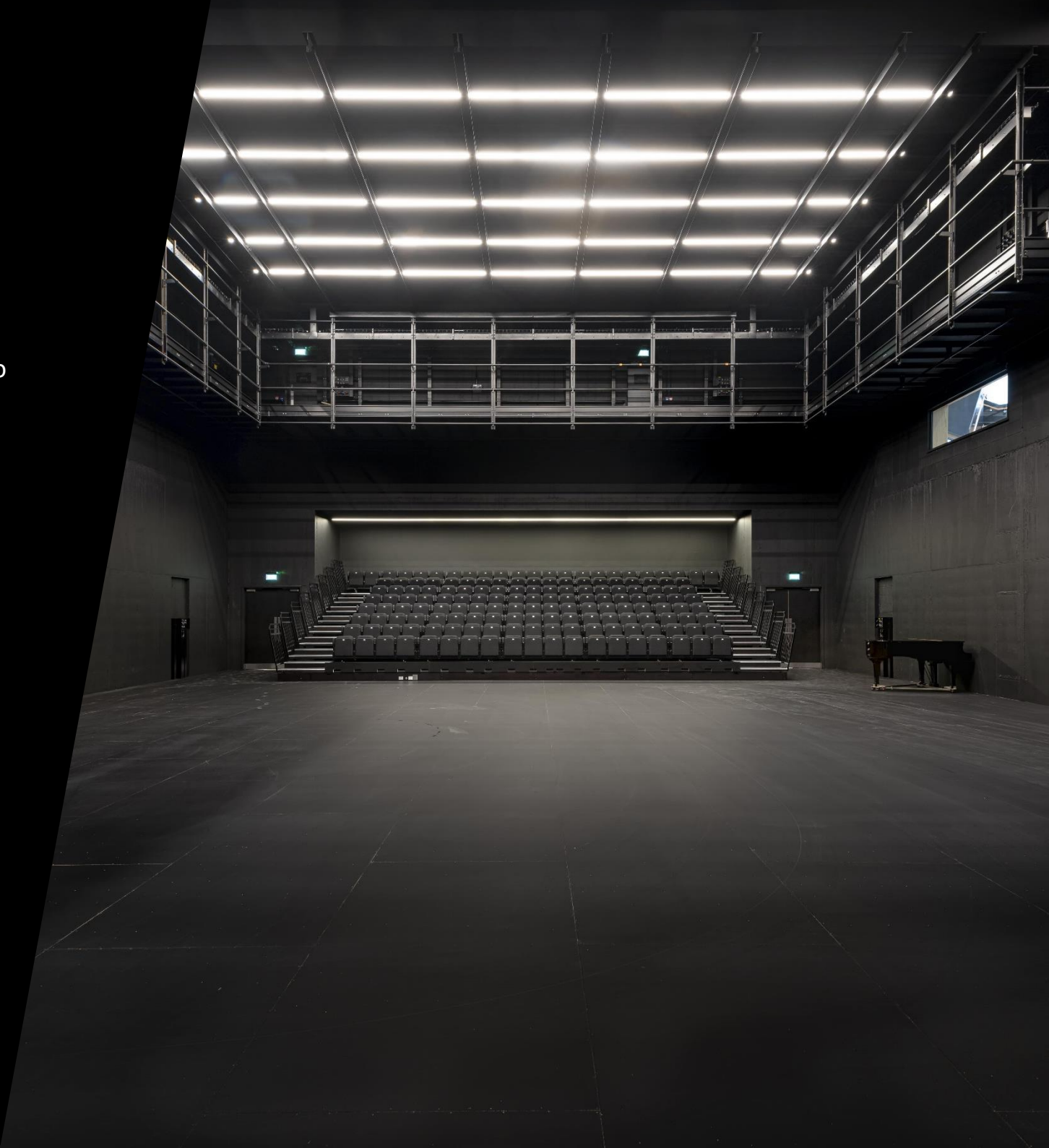

Grey | Weston | Hynd Studios

Our purpose built rehearsal studios offer state of the art facilities. Each hosting mirrors and ballet barres and harlequin sprung floors, they are perfect for rehearsals, workshops and auditions.

The studios can be combined with hire of production offices for workshop and office spaces and the Wigoder Gallery or Roof Garden for break outs for hospitality events.

Features

- Harlequin sprung dance floors
- Piano available to hire in each studio
- Natural light from floor-ceiling window
- Mirrors and ballet barres on 2-3 walls (can be covered)
- 55" Screen
- Surround sound speakers with smart phone dock, CD and DVD player

Size

15 x 15m

Height: 5.5m

Capacity

100 standing

80 seated

[Visit the Rehearsal Studios on our Virtual Tour](#)

Start from £630 pd | £2,800 pw*

* All prices exclude VAT. Please note that prices are starting prices only, based on daytime hire - please contact us for a bespoke quote for evening and/or extended hours use. Weekend rates available upon request.

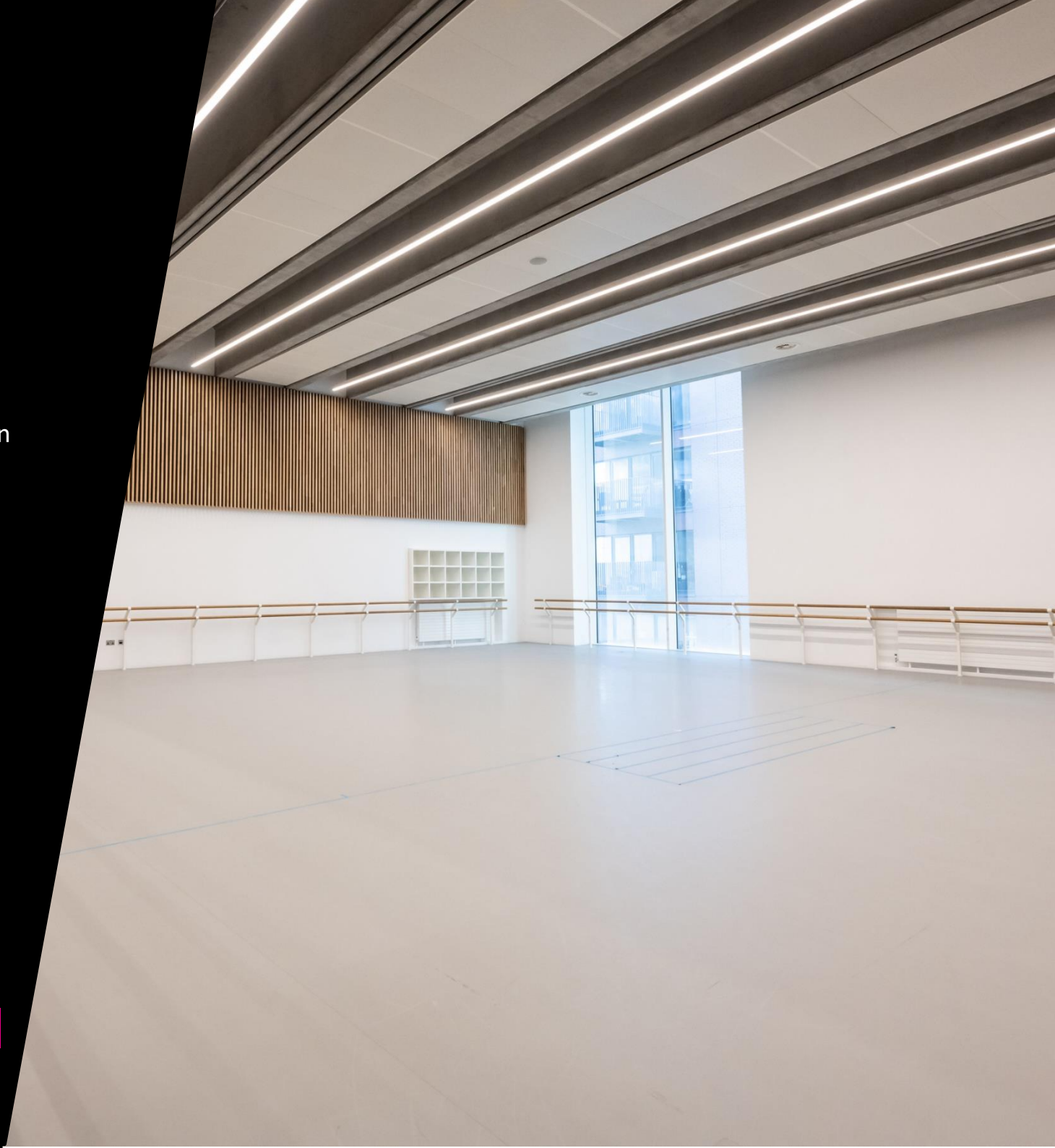

Wigoder Gallery

Our Wigoder Gallery is a contemporary space that overlooks the Dorfman Foyer. The Gallery can be hired as a break-out space in conjunction with our Holloway Productions Studio, or rehearsal spaces.

It is also ideal for large meetings, away days, presentations, drinks receptions, brand activation, networking and training sessions.

Features

- Bespoke Artwork
- Flexible space that can include the Bickle Room for additional capacity
- Contemporary furniture
- Background music system

Size

15 x 9m

Capacity

100 standing
50 seated

[Visit the Wigoder Gallery on our Virtual Tour](#)

Start from £2,000 pd*

* All prices exclude VAT. Please note that prices are starting prices only, based on daytime hire - please contact us for a bespoke quote for evening and/or extended hours use. Weekend rates available upon request.



The Bickle Room

Situated on the first floor of Mulryan Centre for Dance, The Bickle Room is a private and bright space ideal for large boardroom meetings. This space can also be used as a smaller rehearsal room for music and voice calls.

The Bickle Room seats 30 in a boardroom style or smaller seating arrangements. Included in the hire is a large HD screen, speakers, free Wi-Fi and a wireless AV sender.

Features

- Full height windows with lots of natural light
- 82" Screen; HDMI connection
- CD and DVD player
- Wireless presentation gateway
- Can be combined with the Wigoder Gallery to create a larger space, or to accommodate a separate catering area

Size

9 x 7m

Capacity

60 standing
30 seated

[Visit the Bickle Room on our Virtual Tour](#)

Start from £500 pd | £2,250 pw*

* All prices exclude VAT. Please note that prices are starting prices only, based on daytime hire - please contact us for a bespoke quote for evening and/or extended hours use. Weekend rates available upon request.



4th Floor Office

The 4th Floor Office is a wonderful addition to bookings of the Rehearsal Studios to be used as a production office or workshop space

The space can also be used individually for large meetings and includes smaller secluded areas, ideal for taking calls or for hosting private meetings. There is also a small kitchen with fridge, kettle and microwave.

[Please visit the space on our virtual tour here](#)

Start from £450 pd | £2,025 pw*



4th Floor Green Room

The 4th Floor Green Room can be used individually, or is also the perfect addition to Rehearsal Studio bookings.

The space includes a small kitchen with a fridge, kettle and microwave.

[Please visit the space on our virtual tour here.](#)

Start from £450 pd | £2,025 pw*

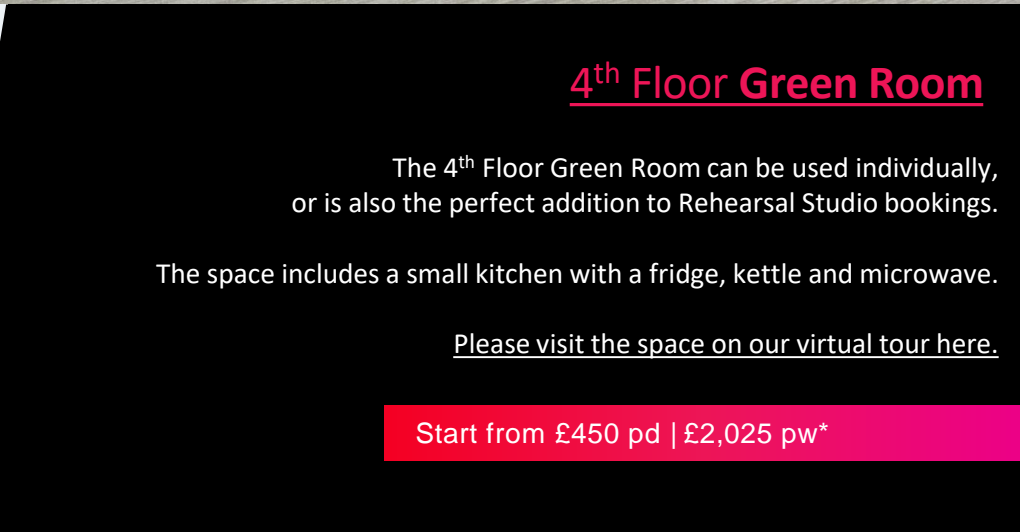

4th Floor Triangle Room

The 4th Floor Triangle room can be hired in addition to Rehearsal Studio bookings and is the ideal space to be used as a production office.

The space includes a small kitchen with a fridge, kettle and microwave. [Please visit the space on our virtual tour here.](#)

Start from £400 pd | £1,800 pw*



3rd Floor Meeting Rooms

Our 3rd Floor meeting rooms are ideal for away days, meetings and as an additional breakout spaces.

Within both meeting rooms is a large HD screen, which can be connected to your laptop via HDMI.

The 3rd floor meeting rooms can accommodate up to 4, or up to 10 guests.

Features

- Boardroom layout
- Contemporary furniture
- HD Screen; HDMI connection
- Complementary access to WiFi

Capacity

Meeting room 4 : 10 seated

Meeting room 3: 4 seated



Start from £250 pd | £1,125 pw*

* All prices exclude VAT. Please note that prices are starting prices only, based on daytime hire - please contact us for a bespoke quote for evening and/or extended hours use. Weekend rates available upon request.

Roof Terrace

The Roof Terrace is a wonderful space for hosting drinks receptions and networking, as well as social employee events.

The space offers views of the Catching Colour installation, within the island's Botanical Square Garden

It can be combined with the fourth floor rehearsal studios as a daytime breakout areas, or evening reception space.

Features

- Fantastic views across London City Island
- Outside space
- Wonderful addition to hires of the rehearsal studios

Capacity

60 standing
40 seated

Start from £2,000 pd*

* All prices exclude VAT. Please note that prices are starting prices only, based on daytime hire - please contact us for a bespoke quote for evening and/or extended hours use. Weekend rates available upon request,

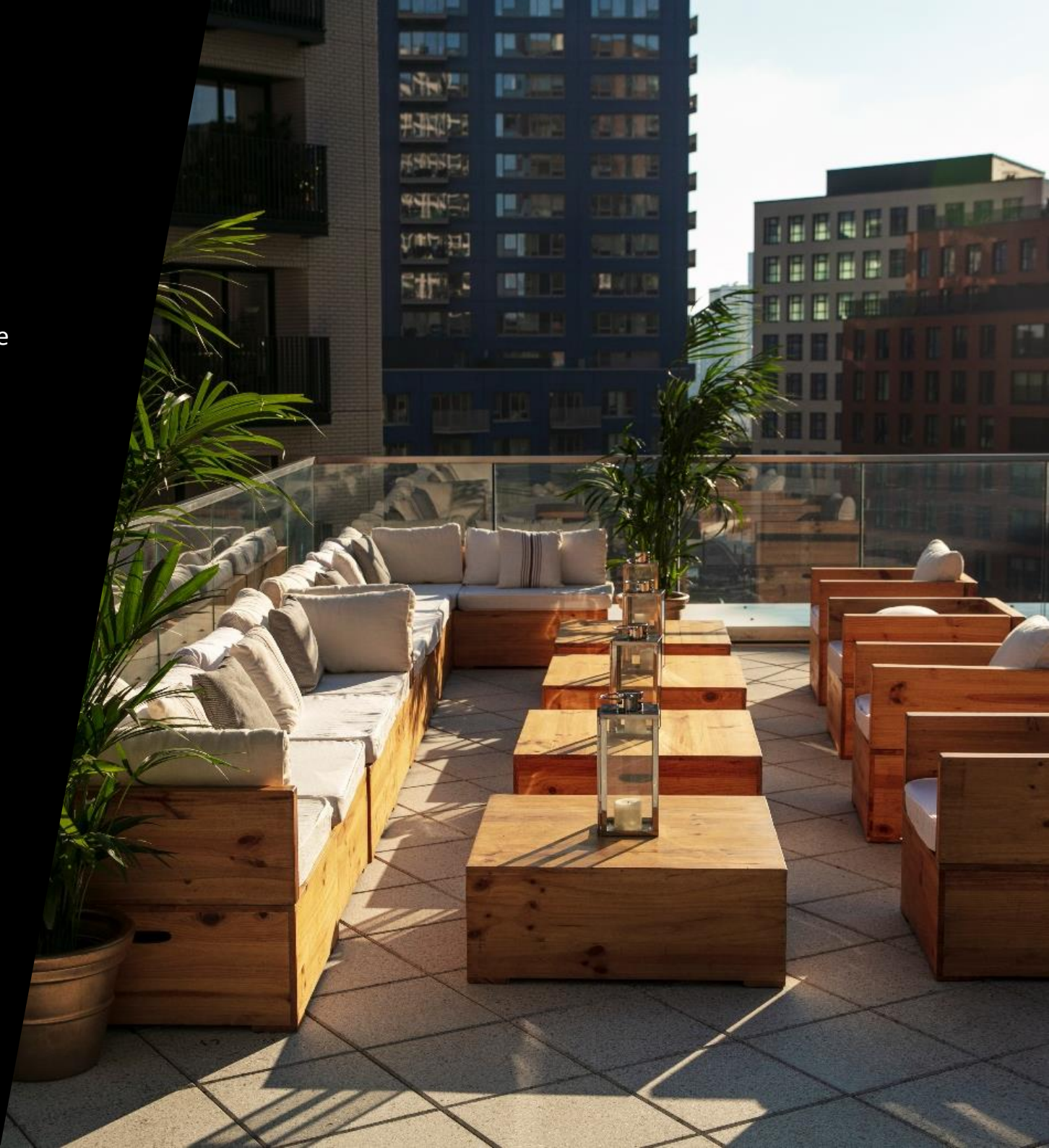



Filming & photography

The Mulryan Centre for Dance is a contemporary building that offers an ideal backdrop for filming and photo shoots. Please enquire for more information; prices available on request.

The image shows the English National Ballet building, a modern structure with a prominent red tower and a white base. The building is surrounded by lush greenery, including a large tree in the foreground and various shrubs. The scene is set in a bright, sunny environment.

English
National
Ballet

Getting to the Mulryan Centre for Dance

Please see more information online about [getting here](#).

By Underground/DLR

Canning Town station: Jubilee Line & DLR, 5 minute walk

The Mulryan Centre for Dance is on London City Island, a short walk from Canning Town station. Exit the barriers and turn left towards the Bow Creek exit, taking the lift or stairs to street level. Then cross the red bridge onto London City Island and the Mulryan Centre for Dance is directly ahead of you.

By Bike

Cycle Superhighway (Hyde Park to Barking) passes close by and is around a 2 minute cycle from the Mulryan Centre for Dance. There are multiple bike racks around the Island.

The nearest Santander cycle docking station is by East India station (DLR), 14 minute walk.

By Bus

Routes 5, 69, 115, 147, 241, 300, 309, 323, 330 stop at Canning Town Bus Station.

Route D3 stops at Leamouth/Orchard Place.

By Car

The Mulryan Centre for Dance is outside of the Congestion Charge Zone, but within the ULEZ and LEZ Zones.

More information about arriving by car [can be found here](#).

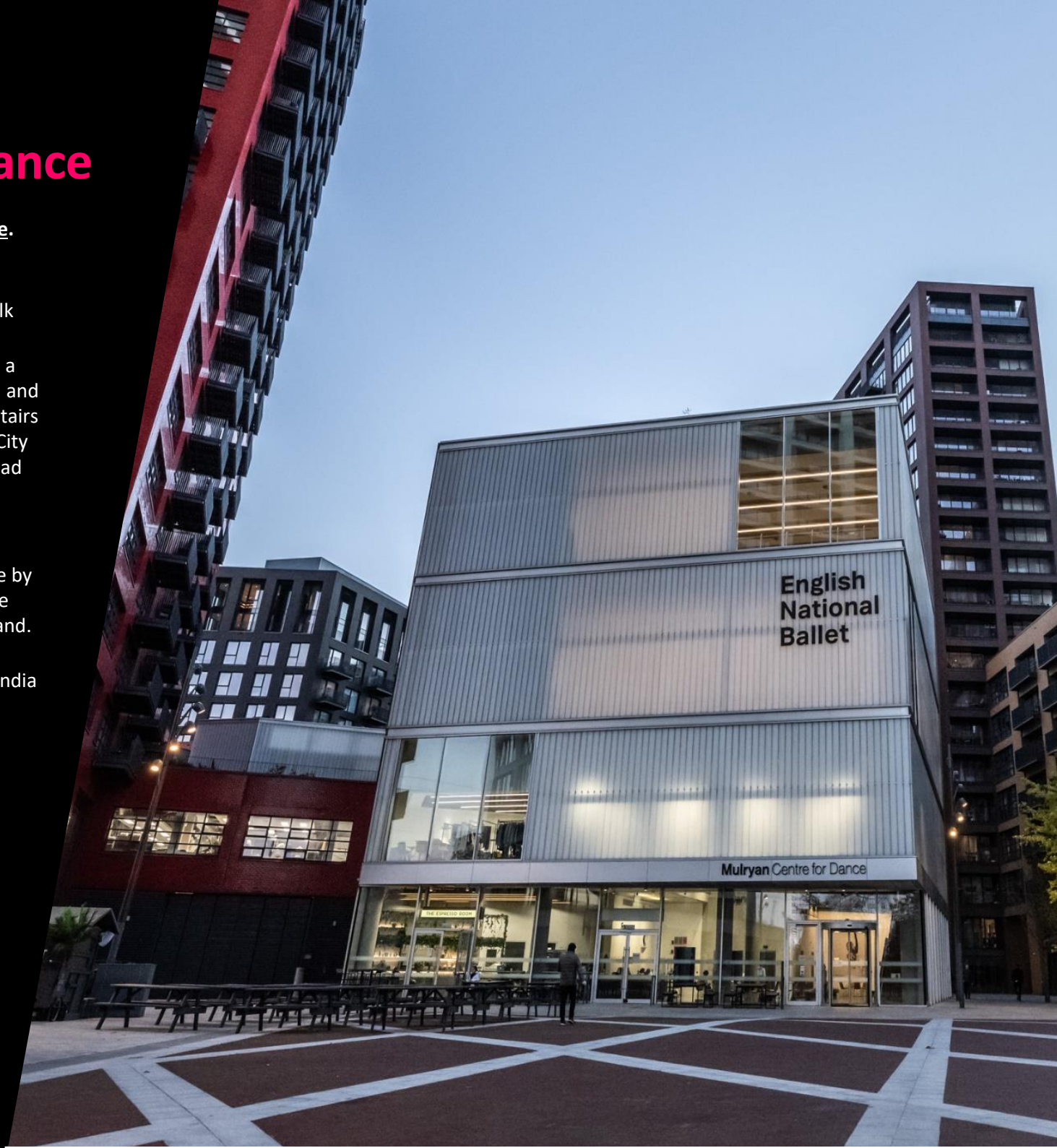



For further details, please contact:

T: 020 7581 1245

E: venuehire@ballet.org.uk

© 2019 English National Ballet. All rights reserved.

Registered in England and Wales. No. 735040. Charity No. 214005 Registered office: 41 Hopewell Square, London E14 0SY