



Studios and Event Space at London City Island



# About English National Ballet at London City Island

This state-of-the-art building is home to English National Ballet and offers production, rehearsal and event facilities, just a 5 minute tube journey from Canary Wharf and with easy vehicular access from the A13. With a Production Studio including a full fly tower, 4 rehearsal studios, acoustically treated music room and various other meeting and hospitality spaces, English National Ballet at London City Island offers creative spaces in which hirers can develop, create, share and promote their work and practice.

## Using the Spaces

- Technical & Production
- Meetings
- Training
- PR & Brand Activation
- Networking & cultivation
- Rehearsals & Studio Performances
- Auditions





# Space Specifications

## Production Studio

The Production Studio is a blank canvas and can be a productive technical theatre space, an engaging conference or training space, and can transform into magical hospitality spaces. With a full height fly tower and a stage space to match our largest theatres, the Production Studio offers a technical space in which to rehearse and produce performances. It is incredibly versatile and can also be used as a dining space, presentation and training venue and for showcasing brands and organisations.

**Perfect for:**

Performance production, Presentations, Dinners & social events, Brand Activation, Fashion shows, Conference plenary sessions, Filming & photography.

**Size:** 19m x 26m  
Floor to top of Flytower 24.2m

**Capacity:** 500 standing  
500 theatre  
350 dining  
250 cabaret

**Features:**

Full height fly tower and access from loading bay Bleacher seating for 175 with more seating available according to preferred layout  
Space can be split into different segments e.g. presentation space & hospitality space or running wardrobe/company office space as well as stage area  
Piano

Foyer and Production Studio used together - 1000 standing

There is free wifi throughout the building and, subject to availability, hirers may have use of the Green Room, public changing rooms and hot desk facilities.

# Rehearsal Studios

**Perfect for:**

Rehearsals, Workshops, Training sessions, Conference breakout spaces, Private performances, Drinks receptions, Filming and Photography.

- Size:**15 x 15 x 5.5m
- Capacity:**Studios 2 & 5 (northern)  
200 standing  
100 seated  
  
Studios 3 & 4 (side)  
Up to 150

**Features:**

- Piano in each studio
- Natural light from floor-ceiling windows
- Mirrors & ballet barres on 3-4 walls (can be covered)
- 55” Screen
- CD & DVD player; ipod/iphone dock
- Speakers

# Music Room

The music room has been designed to provide optimum acoustic conditions for various type of music performances. The layout of sound reflectors/sound absorbers offers both clarity and fullness of sound for the pleasure of the audience and the musicians.

**Perfect for:**

- Auditions, music rehearsal
- Size:**9 x 8m
- Capacity:**60 standing  
50 theatre layout  
40 classroom  
30 seated

**Features:**

- Grand Piano
- Floor boxes with power outlets for varied set-ups

# Collaboration Space

**Perfect for:**

- Meetings, Presentations, Training sessions, Drinks receptions
- Size:**5.4 x 11m
- Capacity:**60 standing  
30 seated  
22 boardroom table

**Features:**

- Can be opened to include the Mezzanine level for hospitality
- Full height windows with views across the river
- 82” Screen; HDMI connection
- CD & DVD player
- Wireless presentation gateway

## Mezzanine

---

**Perfect for:**

Presentations, Drinks receptions & social events, Brand Activation, Networking, Training sessions

**Size:** 15 x 9m

**Capacity:** 150 standing  
100 classroom  
75 seated  
70 cabaret

Mezzanine and Collaboration Space used together 200 standing

**Features:**

Flexible space that can include the Collaboration Space for additional capacity  
Hire can include lighting and AV support

## Roof Terrace

---

**Perfect for:**

Drinks receptions, networking, social events

**Size:** 15 x 7m

**Capacity:** 60 standing

**Features:**

Fantastic views across London City Island  
Stylish outdoor furniture

## Foyer

---

**Perfect for:**

Bespoke performances, drinks receptions, networking

**Size:** 361sqm

**Capacity:** 600 standing  
300 watching a performance

**Features:**

Bespoke artwork on the walls  
Easily accessible, open space  
Feature staircase at the centre of the space

## Meeting Rooms

---

**Perfect for:**

Meetings, small presentations

**Size:** 5.6m x 3.4m or 5.5m x 5m

**Capacity:** 3rd floor rooms 10 or 6  
1st floor rooms 10 or 4

**Features:**

Simple elegant interior design and furniture  
Presentation screen  
HDMI connection

## Hospitality at ENB

---

We can provide a wide range of catering and hospitality options according to the needs of your event. From 4 course dinners to production catering and from our elegant canape menu to working lunches, we provide high quality food and drink that fits with your requirements.



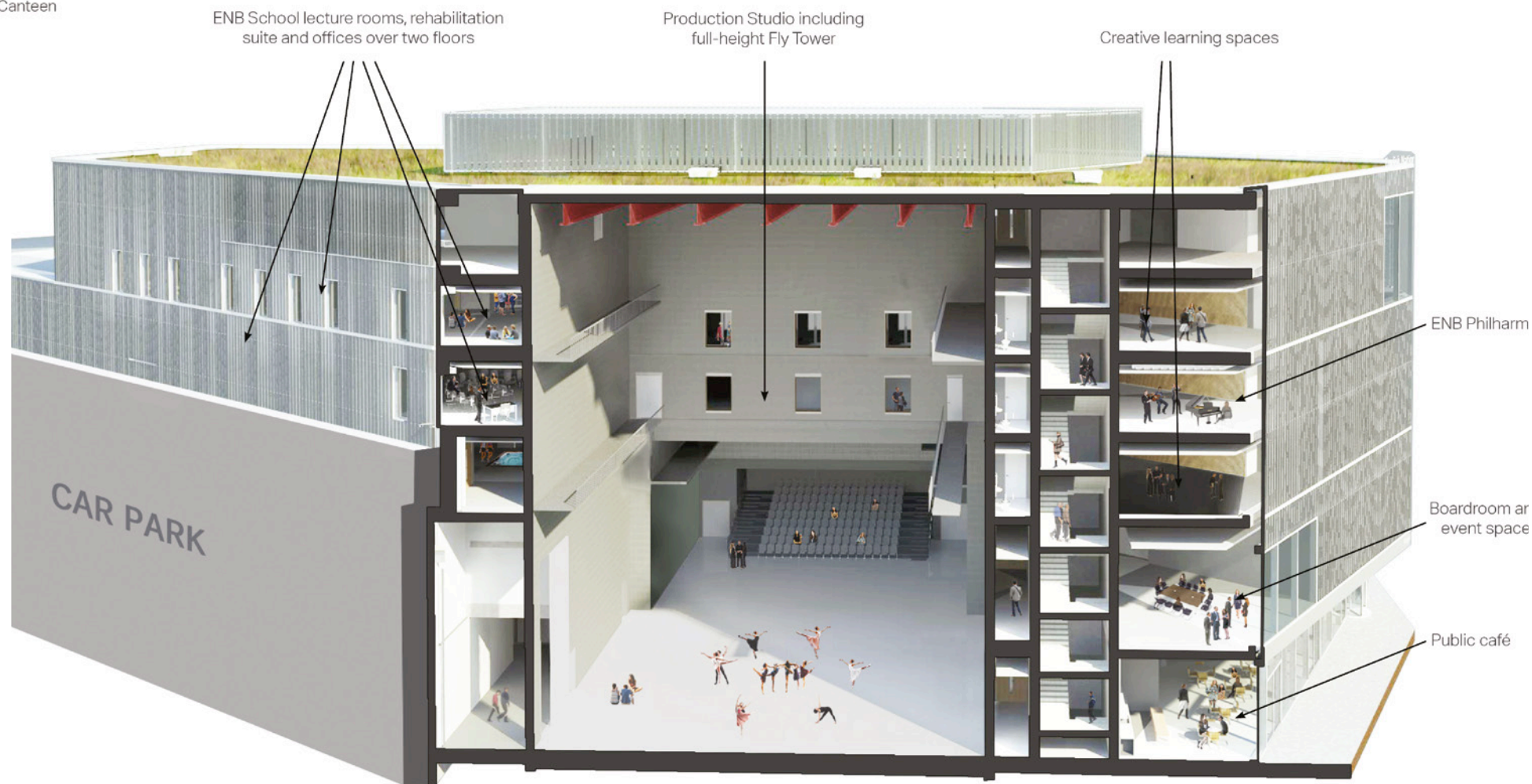
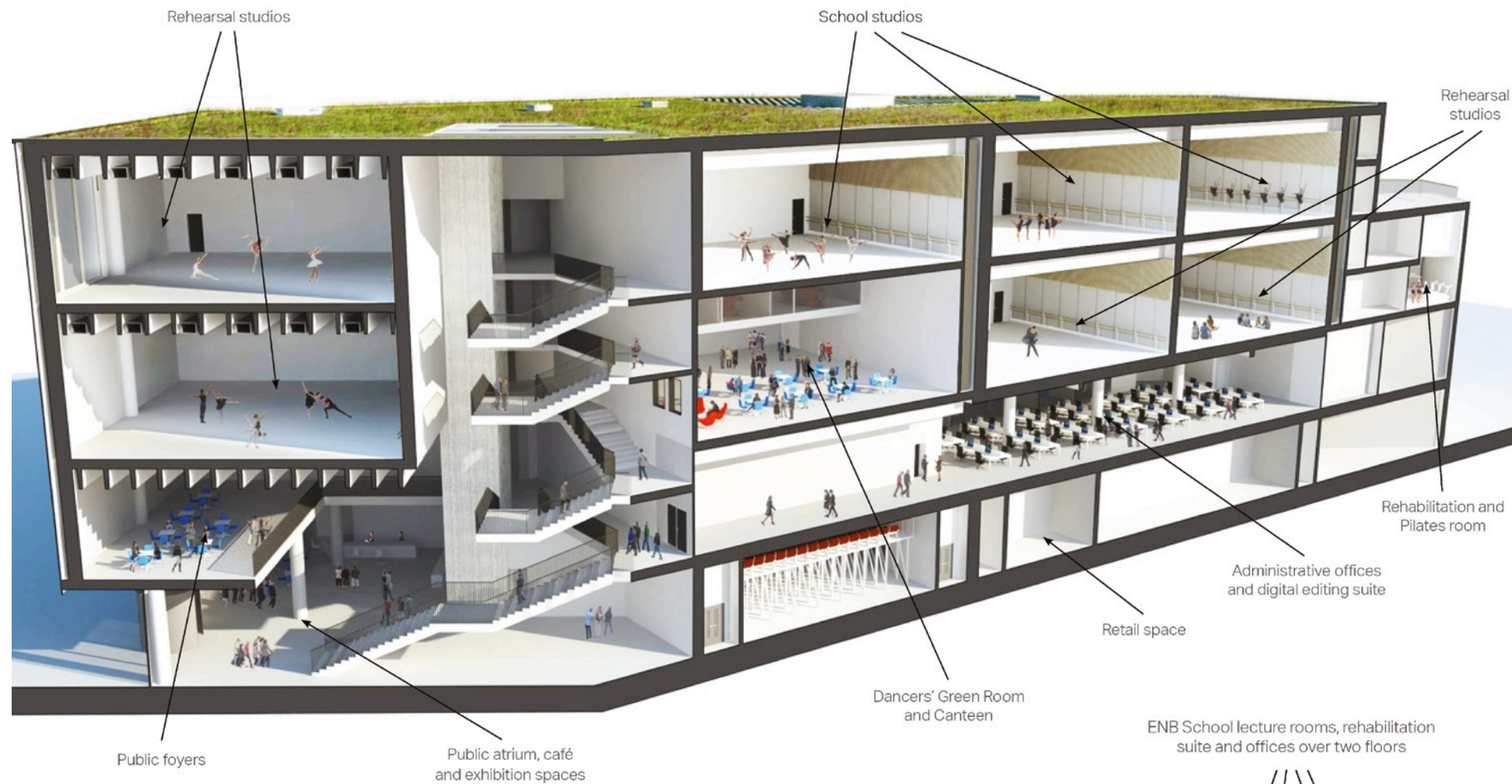





## Contact

[hire@ballet.org.uk](mailto:hire@ballet.org.uk) • 02075811245 • [www.ballet.org.uk/venue-hire](http://www.ballet.org.uk/venue-hire)

© November 2018 English National Ballet